

Technical Data

Specifications

Certifications*: UL, CSA
 Interrupting Capacity: 1000A
 Resettable Overload Capacity: 10 times rated current
 Dielectric Strength: 1,500VAC 1 minute
 Insulation Resistance: 100 MΩ

Voltage Drop: Less than 0.25V
 Temperature Rise at Terminal Block: Less than 117°F (65°C)
 at 100% of rated current applied continuously at 70°F (25°C)
 Base Material: Nylon 66 UL 94-V2
 Actuator Material: Polycarbonate (PC) UL 94-V2

Capacity Correction Factors For Ambient Temperatures								
Current Rating Amps	Temperature							
	°F	+50	+68	+77	+86	+104	+122	+140
	°C	+10	+20	+25	+30	+40	+50	+60
5 to 15A	.90	.95	1.00	1.10	1.32	1.61	2.15	

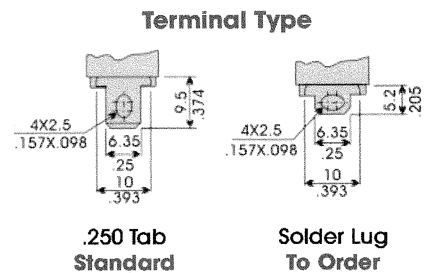
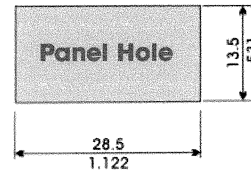
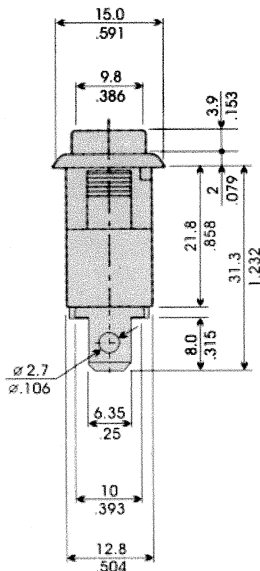
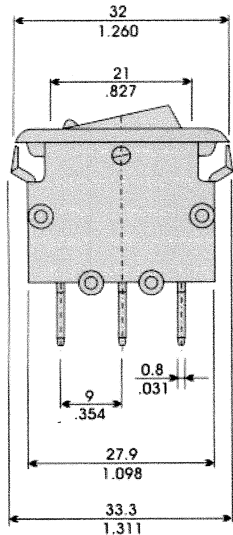
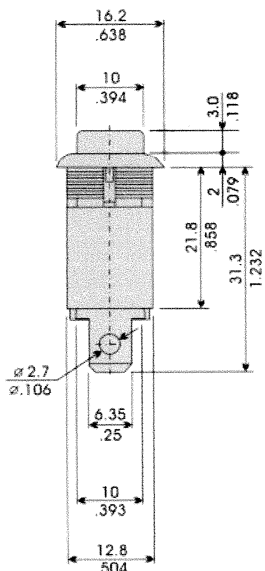
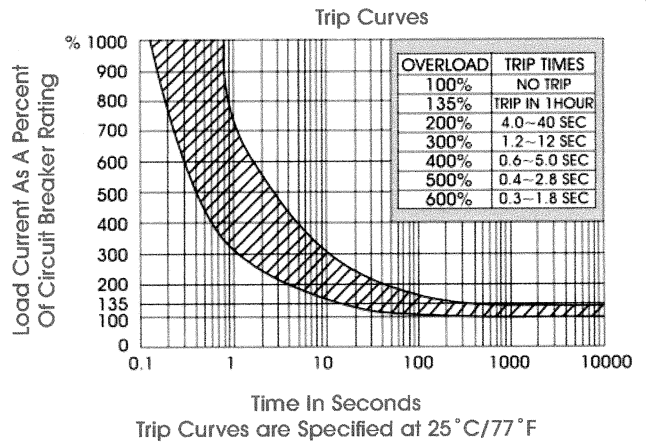
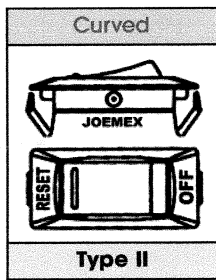
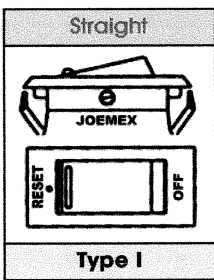

Ordering: (Standard products in red)

M I L	1 0	B	1	B	2 or R	3
Series	Rating	Voltage	Terminal	Style & Base Colour	Rocker Colour	Marking Option
M1 Non-Illuminated M1L Illuminated	05 05A 06 06A 07 07A 08 08A 10 10A 12 12A 15 15A 16 16A 20 20A	A 125VAC B 250VAC	1 .250 Tab 2 Solder Lug	Type I 1 Black 2 White 3 Grey 4 Ivory Type II B Black C White D Grey	Illuminated 1 Amber 2 Red 3 Green Solid Rocker 4 White 5 Black 6 Red 7 Grey Two colour (Type II only) R Black/red S Black/green	0 1 2 Type II (Moulded) 3

Note
 The maximum short circuit capacity of 1000A should be protected by a series fuse of 4 times rated current, but not less than 15A

* Due to ongoing technological advances, consult Techna for certification specifics