

TNC - SMA Adapter

Features

- Used to enable connections between two connector types that would otherwise not mate
- Can also be used to protect connectors on expensive equipment where the number of connect / disconnect cycles is high
- Gold plated brass contact



Specification

Adapter Type	Straight
Connector Type A	TNC Plug
Connector Type B	SMA Socket
Impedance	50 Ohm
Frequency Range	0 ... 6 GHz
Standing Wave Ratio (VSWR)	1.5 max.
Dielectric Withstanding Voltage	750 VRMS
Insulation Resistance	5 GOhm min.
Operating Temperature	-65 ... 165 °C

Drawing

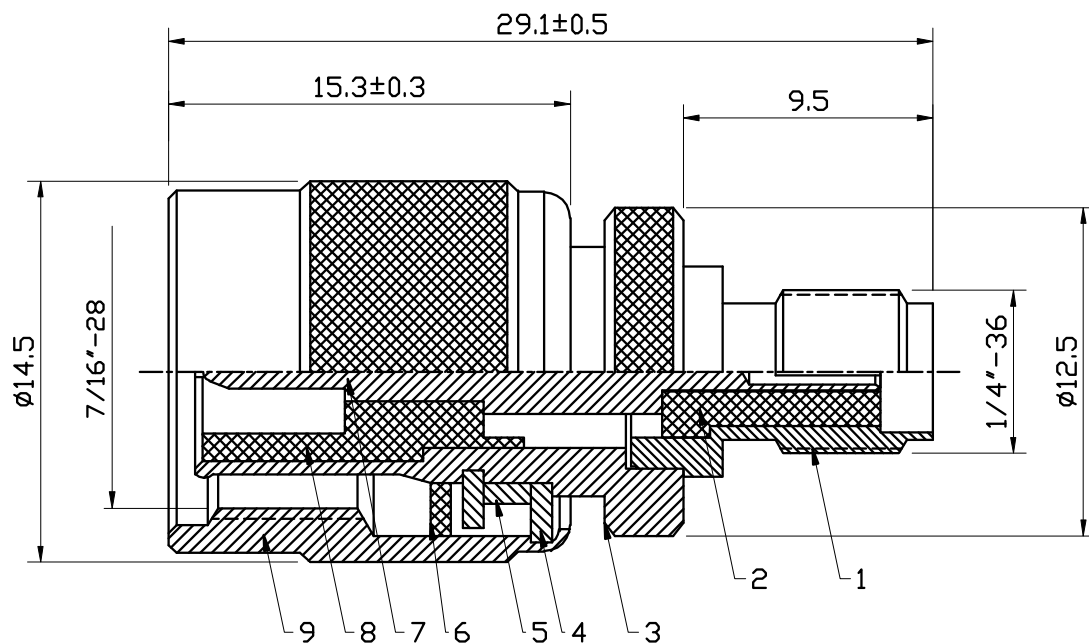

Material Specification

1 - Body	Brass, Nickel Plated
2 - Insulator	PTFE, White
3 - Body	Brass, Nickel Plated
4 - Washer	Steel
5 - Retaining Ring	Brass, Nickel Plated
6 - Gasket	PVC
7 - Center Pin	Brass, Gold Plated
8 - Insulator	POM
9 - Shell	Brass, Nickel Plated

Art Nr.

RND 205-01395