

# CAM SWITCHES

## ► Technical Specifications

UL/CSA Characteristics	PR 12	PR 17	PR 21	PR 26	PR 40	PR 63	PR 125	PR 160
<b>► UL/CSA</b>								
1 PHASE 110/120 VAC	0.5 HP	1 HP	1.5 HP	2 HP	3 HP	5 HP	N/A	N/A
3 PHASE 110/120 VAC 220/240 VAC 440/480 VAC 550/600 VAC	1 HP	2 HP	3 HP	3 HP	7.5 HP	10 HP	N/A	N/A
	3 HP	5 HP	5 HP	7.5 HP	15 HP	20 HP	N/A	N/A
	5 HP	7.5 HP	10 HP	15 HP	30 HP	40 HP	N/A	N/A
	3 HP	10 HP	15 HP	20 HP	30 HP	40 HP	N/A	N/A
GENERAL USE (600 V) (MOTOR CONTROLLER)	12 A	16A	20 A	25 A	50 A	63 A	N/A	N/A
UL 508 RECOGNIZED	YES	YES	YES	YES	YES	YES	No	No
CSA CERTIFIED	YES	YES	YES	YES	YES	YES	No	No
<b>IEC Characteristics</b>								
<b>► For thermal current AC-20 lth I<sub>c</sub>(A)</b> (IEC 60 947-3)	20	25	32	40	63	80	200	250
<b>► Rated operating current for AC-21 A I<sub>e</sub>(A)</b> (IEC 60 947-3) Switching of resistive loads including moderate overloads	16	20	25	32	50	80	160	200
<b>► Rated operating current for AC-15 A I<sub>e</sub>(A) at 230V AC</b> (IEC 60 947-3) Control of electromagnetic loads	6	8	10	12	-	-	-	-
<b>► Performance in AC 23 (kW)</b> (IEC 60 947-3) Switching of motors or other highly inductive loads								
- 3 x 230 V	4	5.5	7.5	11	15	18.5	-	-
- 3 x 400 V	7.5	11	11	11	22	25	-	-
- 3 x 500 V	5.5	11	11	11	25	25	-	-
- 3 x 690 V	4	10	10	11	18.5	22	-	-
<b>► Performance in AC 3</b> (IEC 60 947-3) Control of squirrel-cage motors starting and switching off motors while running - In kW								
- 3 x 230 V	3	4	4	5.5	11	15	-	-
- 3 x 400 V	4	7.5	7.5	11	18.5	22	-	-
- 3 x 500 V	5.5	7.5	7.5	11	18.5	22	-	-
- 3 x 690 V	3	7.5	7.5	11	18.5	22	-	-

## CAM SWITCHES

### ► Technical Specifications

IEC Characteristics	PR 12	PR 17	PR 21	PR 26	PR 40	PR 63	PR 125	PR 160
<b>► Performance in AC 3 - cont.</b>								
- In HP (for reference)								
- 3 x 230 V	4	5.5	5.5	7.5	15	20	-	-
- 3 x 400 V	5.5	10	10	15	25	30	-	-
- 3 x 500 V	7.5	10	10	15	25	30	-	-
- 3 x 690 V	4	10	10	15	25	30	-	-
<b>► Rated insulation voltage <math>U_i</math> (V)</b>								
- Max. rated voltage $U_e(v)$ IEC	690	690	690	690	690	690	690	690
- CSA (Canada)	600	600	600	600	600	600	600	600
- UL (USA)	600	600	600	600	600	600	600	600
<b>► Rated short time withstand current <math>I_{cw}</math> (A) for 1 sec</b>								
	250	400	420	800	1000	1000	2000	2400
<b>► Maximum wire size (mm<sup>2</sup>)</b>								
- rigid	4	6/4 <sup>(1)</sup>	6/4 <sup>(1)</sup>	6	16	16	ø 8 screw for eyelet	
- flexible	2.5	4	4	6	16	16	ø 8 screw for eyelet	
<b>► Maximum wire size (AWG)</b>								
- rigid	10	8/10 <sup>(1)</sup>	8/10 <sup>(1)</sup>	8	6	6		
- flexible	14	12	12	8	6	6		
(1): These values correspond to terminals with jumpers								
<b>► Mechanical durability</b> 1,250,000 operations, maximum rate 150 operations per hour								
<b>► Operating temperature limits</b> - 20°C to + 70°C - 4°F to + 158°F (beyond these limits consult us)								
<b>► Rated operating current in DC-1 low inductive loads (&lt; 1 ms)</b>								
Rated operating current $I_e$ (A) 24 V DC	PR 12	PR 17	PR 21	PR 26	PR 40	PR 63	PR 125	PR 160
	16	20	25	32	50	80	-	-
$I_e$ (A): rated current for breaking 1 contact. For higher voltages you must use a reduction coefficient K in the following graph								

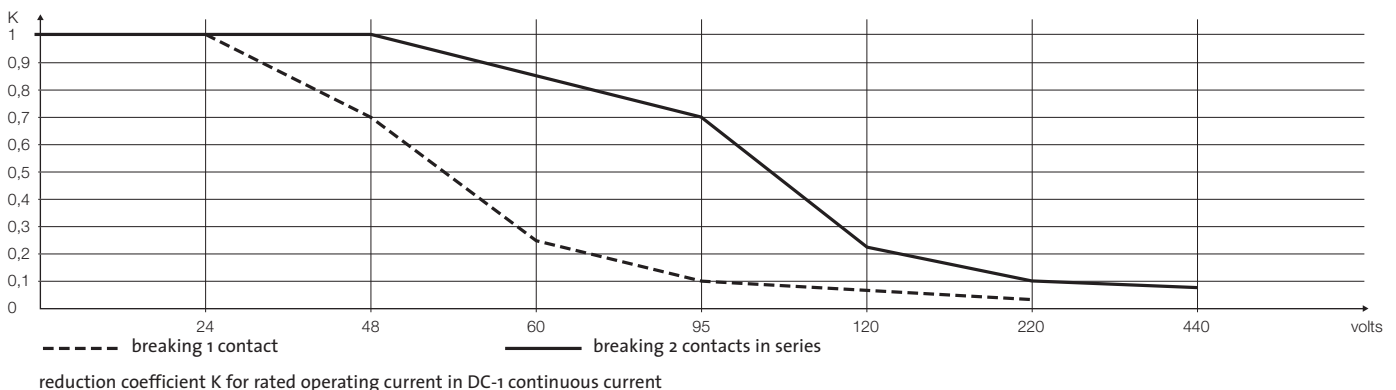

# CAM SWITCHES

## ► Mounting

### 2 SCREWS - 30 OR 50 MM INTERVAL

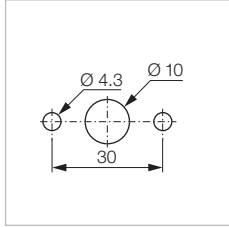

PR 12  
PR 17  
PR 21  
PR 26

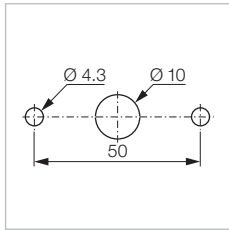
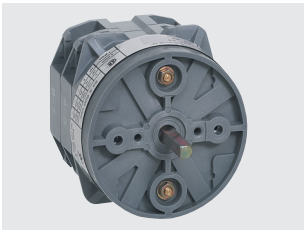

PR 40  
PR 63

### SINGLE HOLE MOUNTING Ø 22

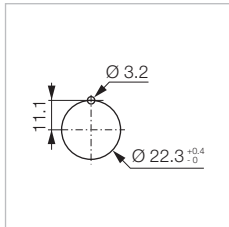

For PR12 only

- 48 legend plate with handle
- HANDLE
- LEVER
- KEY

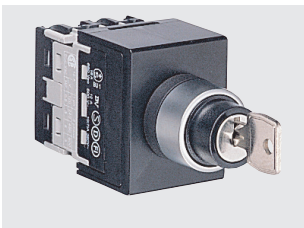

# CAM SWITCHES

## ► Dimensions

### 2 SCREW FRONT MOUNTING (E)

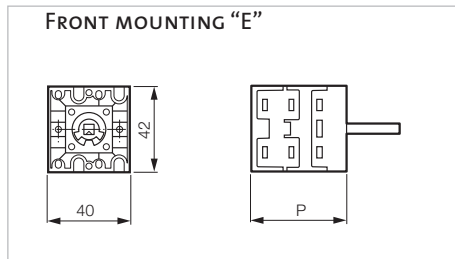

PR 12	No. of contacts	P*
	1-2	36
	3-4	46
	5-6	56
	7-8	66
	9-10	76
	11-12	86

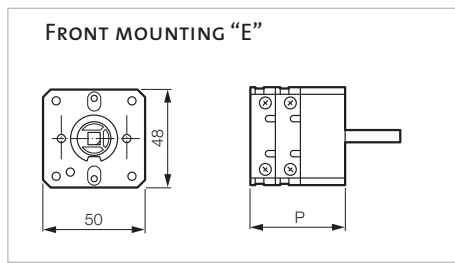

PR 17/21	No. of contacts	P*
	1-2	33
	3-4	45
	5-6	57
	7-8	69
	9-10	81
	11-12	93

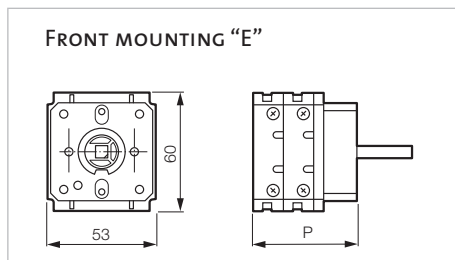

PR 26	No. of contacts	P*
	1-2	36
	3-4	51
	5-6	66
	7-8	81
	9-10	96
	11-12	111

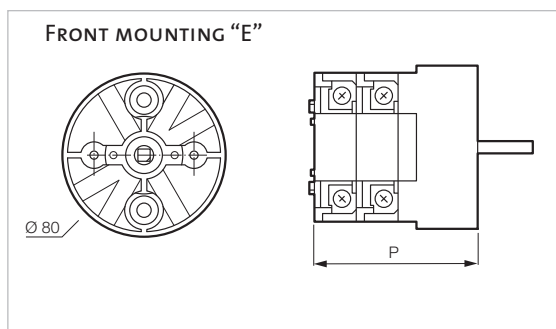

PR 40/63	No. of contacts	P*
	1-2	60
	3-4	80
	5-6	100
	7-8	120
	9-10	140
	11-12	160

# CAM SWITCHES

## ► Dimensions

### SINGLE HOLE MOUNTING Ø 22

FRONT MOUNTING "E N48MD50"

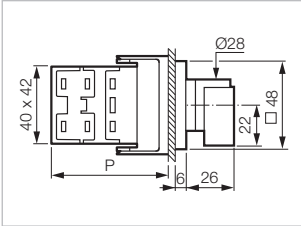

**WITH HANDLE AND  
LEGEND PLATE**

No. of contacts	P*
1-2	51
3-4	61
5-6	71
7-8	81
9-10	91
11-12	101

FRONT MOUNTING "E C21RA03"

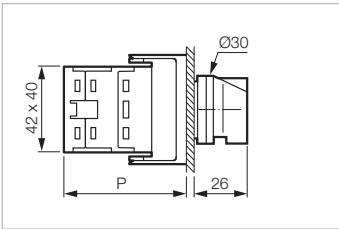

**WITH HANDLE  
OR LEVER**

No. of contacts	P*
1-2	51
3-4	61
5-6	71
7-8	81
9-10	91
11-12	101

FRONT MOUNTING "E C21RC00"

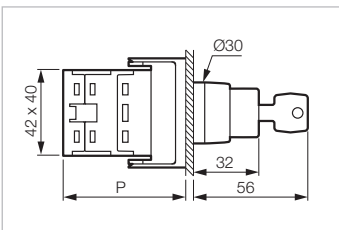

**WITH KEY**

No. of contacts	P*
1-2	51
3-4	61
5-6	71
7-8	81
9-10	91
11-12	101

## CAM SWITCHES

### ► Dimensions

#### ENCLOSURES

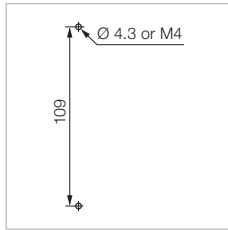
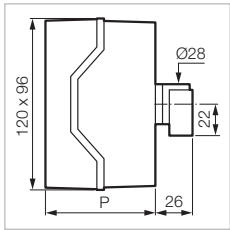

PR 12	No. of contacts	P*
	1-6	77
	7-10	101

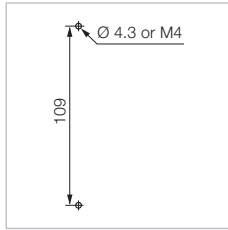
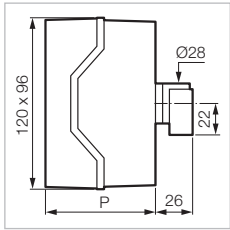

PR 17/21	No. of contacts	P*
	1-6	77
	7-10	101

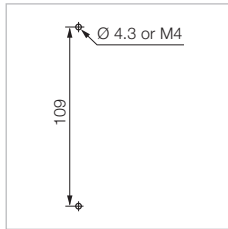
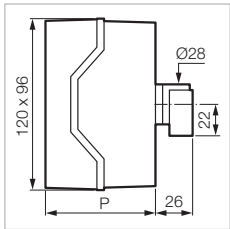

PR 26	No. of contacts	P*
	1-4	77
	5-8	101

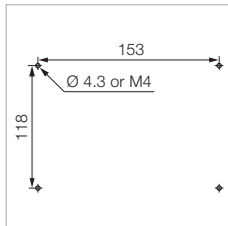
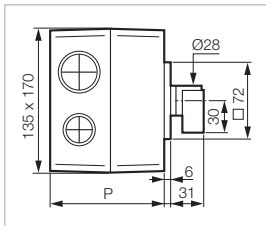

PR 40/63	No. of contacts	P*
	1-4	107
	5-8	145

